



## Acme Sanitary Ware Co Ltd

Acme Building, 22-28 Nanking Street, Kowloon, Hong Kong  
 Tel: 2388 7171 Fax: 2710 8012  
 E-mail: acme@acmesanitary.com.hk  
 Website: www.acmesanitaryware.com.hk



Pure Freude  
an Wasser

PROJECT		REF		REV	ITEM CODE	
LOCATION		DATE			PAGE	

## SANITARY WARE SPECIFICATION SHEET

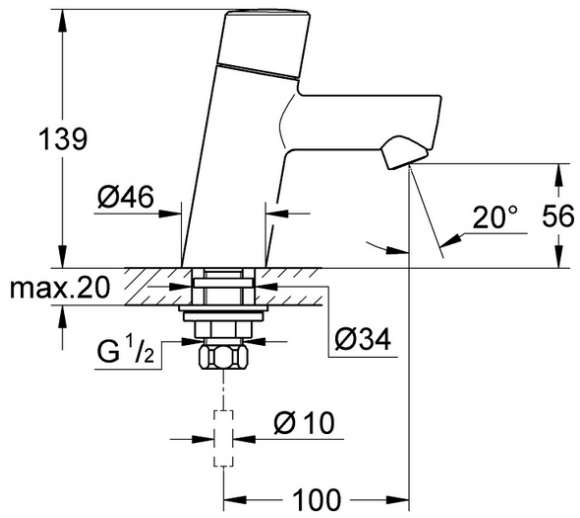
Item Descriptions	GROHE (Germany) "Concetto" Chrome plated pillar tap XS-Size	Illustration/ Drawing
Dimensions	L100 x W46 x H139 mm	
Model	32207001	
Finish	Chrome Plated	
Country of origin	Thailand	
Manufacturer	GROHE AG	
Supplier	Acme Sanitary Ware Co. Ltd Mr. Eric Wong/ Mr. Don Yuen	
Contact Tel/Fax	(852) 2388-7171 / (852) 2710-8012	
E-mail	acme@acmesanitary.com.hk	
Website	www.acmesanitary.com.hk	
<b>"Concetto"</b> <b><u>Pillar tap XS-Size</u></b>  <ul style="list-style-type: none"><li>· monobloc installation</li><li>· metal lever</li><li>· ceramic headparts 1/2", 90°</li><li>· <b>GROHE StarLight</b> chrome finish</li><li>· <b>GROHE EcoJoy</b> SpeedClean mousseur 5.7 l/min</li><li>· union nut 1/2" x 10.5 mm</li><li>· noise classification 1 in accordance with DIN4109</li></ul>		
		

Note:

\* All information of the above is for the reference only. No prior notice is made if any changes.



## Acme Sanitary Ware Co Ltd

Acme Building, 22-28 Nanking Street, Kowloon, Hong Kong  
Tel: 2388 7171 Fax: 2710 8012  
E-mail: acme@acmesanitaryware.com.hk  
Website: www.acmesanitaryware.com.hk



Pure Freude  
an Wasser

PROJECT		REF		REV	ITEM CODE	
LOCATION		DATE			PAGE	

## SANITARY WARE SPECIFICATION SHEET

### GROHE CONCETTO

#### A CYLINDRICAL STATEMENT

Inviting design. The formal beauty of the cylinder and the softness of circular elements are perfectly expressed in the Concetto range. Take pleasure in the harmony and perfect ergonomics of precisely drawn lines, angles and curves. Concetto is an unique expression of pure style. A brilliant feature is the strikingly angled operating lever, subtly inviting you to reach out and touch. The space between pure aesthetics and optimum functionality is bridged brilliantly by the finish of the GROHE StarLight surfaces.

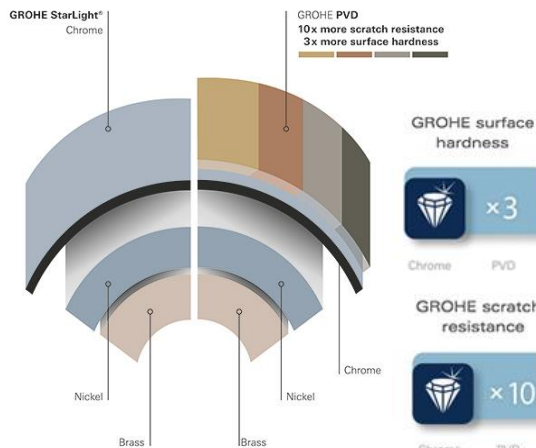

#### Easy to clean thanks to the GROHE StarLight chrome coating

Just wipe the tap down with a dry cloth – the ultra smooth surface finish is scratch resistant and ensures a lasting luminous sheen. You'll save plenty of time cleaning while your tap always looks shiny and new.

#### GROHE EcoJoy with water-saving function for reduced consumption

GROHE EcoJoy reduces water consumption by up to 50% without compromising on performance. Whenever you turn on your tap, you will enjoy a full jet of water while saving money nonetheless.

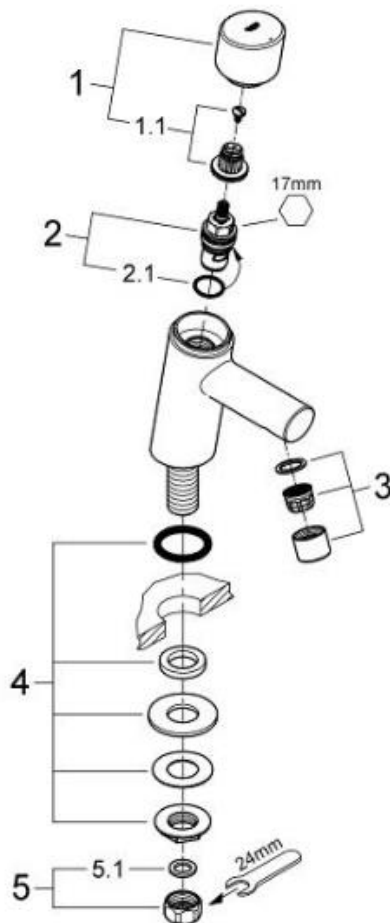

Pos.-nr.	Prod. description	Order-nr.
1	Handle	48071000
1.1	Replacement kit for fastening	45186000
2	Ceramic headpart, 1/2"	45882000
2.1	O-ring Ø 18.2 x Ø 1.7	0392400M
3	Mousseur	13935000
4	Shank fastening assembly 1/2"	45000000
5	Coupling nut 1/2"	1290100M
5.1	Fibre seal Ø 18,5 x Ø 12 x 2	0138900M
* Optional accessories		

Note:

\* All information of the above is for the reference only. No prior notice is made if any changes.